

DESIGNED BY JPS
 CHECKED BY JPS
 DATE PLOTTED 11/21/13
 DATE SHEET PLOTTED 11/21/13
 CADD NO. 100000 - 6.2

REV.	DESCRIPTION	DATE
1	DESIGN CRITERIA	12/17/13

SVE Associates
 Engineering
 Planning
 47 Marlboro Street
 Portsmouth, NH 03801
 Phone: (603) 502-1532
 Fax: (603) 395-0989
 Website: www.sveassociates.com

Project:
LOT 134-6.2
SEPTIC
 CHESTERFIELD, NEW HAMPSHIRE

Prepared by:
CERSOSIMO INDUSTRIES
 1367 BRIDGMAN ROAD
 VENHON, VERMONT

SHEET
C-1

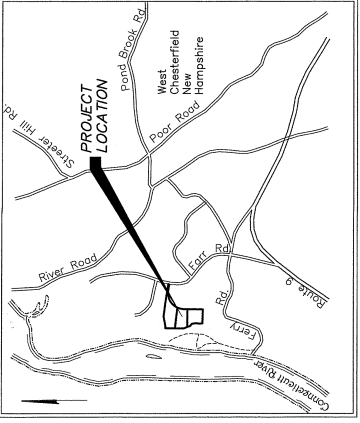

- DESIGN CRITERIA**
1. LOCATION OF STREAMS > 75' LOCATION OF WETLANDS > 75'
 2. LOCATION OF SURFACE AND SUBSURFACE DRAINS > 75'
 3. WATER SUPPLY SOURCE DRILLED WELL
 4. SYSTEM IS NOT DESIGNED FOR A GARBAGE DISPOSAL
 5. SYSTEM IS NOT DESIGNED FOR A BLOWNASH TYPE WATER TREATMENT SYSTEM
 6. SYSTEM TO BE REBUILT IN PLACE IF FAILURE OCCURS
 7. USE: FOUR BEDROOM RESIDENCE
 8. DESIGN FLOW: MAXIMUM DEMAND = 150 GPD PER PERSON (150 GPD PER PERSON) = 600 GPD MAX. DESIGN FLOW FOR 600 GPD
 9. BEDROOMS: 4 @ 300 GPD PER PERSON (300 GPD PER PERSON) = 1200 GPD (TABLE A ENVIRO-SEPTIC DESIGN MANUAL) 200' PROVIDED
 10. SEPTIC TANK CAPACITY: REQUIRED: 1200 GAL. TANK (50% IN STORAGE) 200' PROVIDED
 11. FOUNDATION DRAINS: NONE
 12. SOIL INVESTIGATIONS 05/27/2013 BY SVE ASSOCIATES
 [10B] - HARD VERY FINE SANDY LOAM, 3-8% SLOPES
 SHALL BE CONSTRUCTED AT ELEVATION 804.1; IT IS APPROXIMATELY 3.5' BELOW ORIGINAL GROUND. THE BOTTOM OF THE EFFLUENT DISPOSAL SYSTEM (EDS) AT PEAK FLOW SHALL BE 1.0' BELOW ORIGINAL GROUND. THE BOTTOM OF THE CLEAN OUT SHALL BE APPROXIMATELY 4' BELOW ORIGINAL GROUND. THE BOTTOM OF THE 4" ENVIRO-SEPTIC PIPE SHALL BE APPROXIMATELY 4' BELOW ORIGINAL GROUND. THE BOTTOM OF THE 4" ENVIRO-SEPTIC PIPE SHALL BE APPROXIMATELY 3.5' BELOW ORIGINAL GROUND.
 13. STATE SUBDIVISION PLAT NUMBER: 8402000094.

TYPE	DEPTH	DATE	DEPTH	DATE
1. TEST DATE	12/10/13	12/10/13	12/10/13	12/10/13
2. TEST DATE	12/10/13	12/10/13	12/10/13	12/10/13
3. TEST DATE	12/10/13	12/10/13	12/10/13	12/10/13
4. TEST DATE	12/10/13	12/10/13	12/10/13	12/10/13
5. TEST DATE	12/10/13	12/10/13	12/10/13	12/10/13
6. TEST DATE	12/10/13	12/10/13	12/10/13	12/10/13
7. TEST DATE	12/10/13	12/10/13	12/10/13	12/10/13
8. TEST DATE	12/10/13	12/10/13	12/10/13	12/10/13
9. TEST DATE	12/10/13	12/10/13	12/10/13	12/10/13
10. TEST DATE	12/10/13	12/10/13	12/10/13	12/10/13
11. TEST DATE	12/10/13	12/10/13	12/10/13	12/10/13
12. TEST DATE	12/10/13	12/10/13	12/10/13	12/10/13
13. TEST DATE	12/10/13	12/10/13	12/10/13	12/10/13
14. TEST DATE	12/10/13	12/10/13	12/10/13	12/10/13
15. TEST DATE	12/10/13	12/10/13	12/10/13	12/10/13
16. TEST DATE	12/10/13	12/10/13	12/10/13	12/10/13
17. TEST DATE	12/10/13	12/10/13	12/10/13	12/10/13
18. TEST DATE	12/10/13	12/10/13	12/10/13	12/10/13
19. TEST DATE	12/10/13	12/10/13	12/10/13	12/10/13
20. TEST DATE	12/10/13	12/10/13	12/10/13	12/10/13

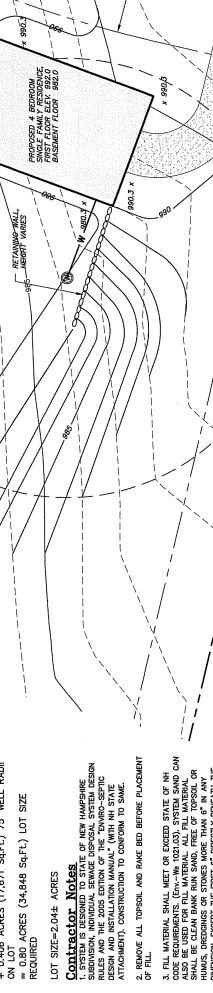
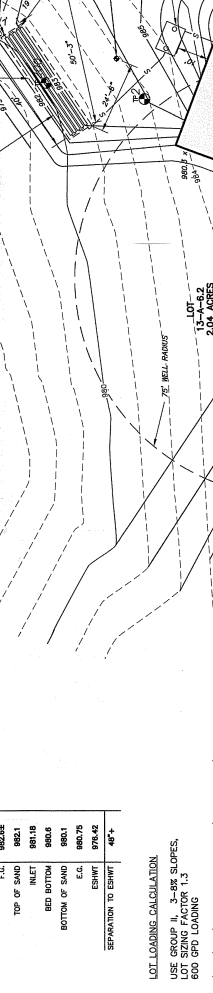
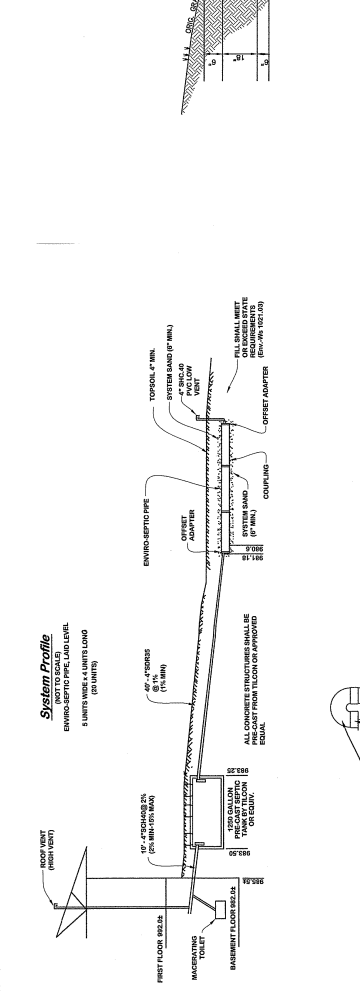
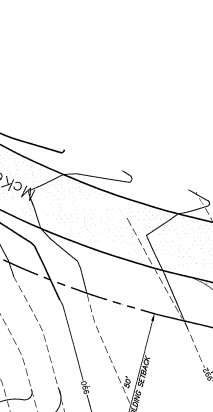
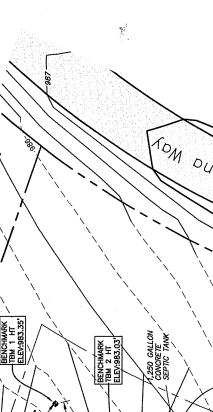
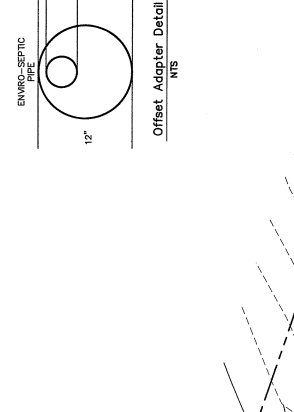
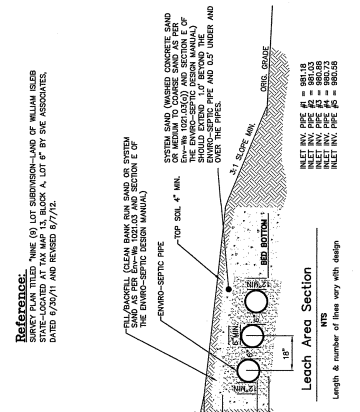
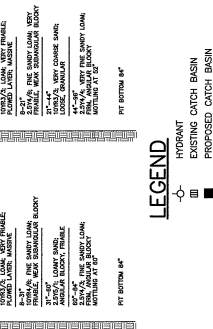

Reference: Plans 13, 14, 15, 16, 17, 18, 19, 20, 21, 22, 23, 24, 25, 26, 27, 28, 29, 30, 31, 32, 33, 34, 35, 36, 37, 38, 39, 40, 41, 42, 43, 44, 45, 46, 47, 48, 49, 50, 51, 52, 53, 54, 55, 56, 57, 58, 59, 60, 61, 62, 63, 64, 65, 66, 67, 68, 69, 70, 71, 72, 73, 74, 75, 76, 77, 78, 79, 80, 81, 82, 83, 84, 85, 86, 87, 88, 89, 90, 91, 92, 93, 94, 95, 96, 97, 98, 99, 100, 101, 102, 103, 104, 105, 106, 107, 108, 109, 110, 111, 112, 113, 114, 115, 116, 117, 118, 119, 120, 121, 122, 123, 124, 125, 126, 127, 128, 129, 130, 131, 132, 133, 134, 135, 136, 137, 138, 139, 140, 141, 142, 143, 144, 145, 146, 147, 148, 149, 150, 151, 152, 153, 154, 155, 156, 157, 158, 159, 160, 161, 162, 163, 164, 165, 166, 167, 168, 169, 170, 171, 172, 173, 174, 175, 176, 177, 178, 179, 180, 181, 182, 183, 184, 185, 186, 187, 188, 189, 190, 191, 192, 193, 194, 195, 196, 197, 198, 199, 200, 201, 202, 203, 204, 205, 206, 207, 208, 209, 210, 211, 212, 213, 214, 215, 216, 217, 218, 219, 220, 221, 222, 223, 224, 225, 226, 227, 228, 229, 230, 231, 232, 233, 234, 235, 236, 237, 238, 239, 240, 241, 242, 243, 244, 245, 246, 247, 248, 249, 250, 251, 252, 253, 254, 255, 256, 257, 258, 259, 260, 261, 262, 263, 264, 265, 266, 267, 268, 269, 270, 271, 272, 273, 274, 275, 276, 277, 278, 279, 280, 281, 282, 283, 284, 285, 286, 287, 288, 289, 290, 291, 292, 293, 294, 295, 296, 297, 298, 299, 300, 301, 302, 303, 304, 305, 306, 307, 308, 309, 310, 311, 312, 313, 314, 315, 316, 317, 318, 319, 320, 321, 322, 323, 324, 325, 326, 327, 328, 329, 330, 331, 332, 333, 334, 335, 336, 337, 338, 339, 340, 341, 342, 343, 344, 345, 346, 347, 348, 349, 350, 351, 352, 353, 354, 355, 356, 357, 358, 359, 360, 361, 362, 363, 364, 365, 366, 367, 368, 369, 370, 371, 372, 373, 374, 375, 376, 377, 378, 379, 380, 381, 382, 383, 384, 385, 386, 387, 388, 389, 390, 391, 392, 393, 394, 395, 396, 397, 398, 399, 400, 401, 402, 403, 404, 405, 406, 407, 408, 409, 410, 411, 412, 413, 414, 415, 416, 417, 418, 419, 420, 421, 422, 423, 424, 425, 426, 427, 428, 429, 430, 431, 432, 433, 434, 435, 436, 437, 438, 439, 440, 441, 442, 443, 444, 445, 446, 447, 448, 449, 450, 451, 452, 453, 454, 455, 456, 457, 458, 459, 460, 461, 462, 463, 464, 465, 466, 467, 468, 469, 470, 471, 472, 473, 474, 475, 476, 477, 478, 479, 480, 481, 482, 483, 484, 485, 486, 487, 488, 489, 490, 491, 492, 493, 494, 495, 496, 497, 498, 499, 500, 501, 502, 503, 504, 505, 506, 507, 508, 509, 510, 511, 512, 513, 514, 515, 516, 517, 518, 519, 520, 521, 522, 523, 524, 525, 526, 527, 528, 529, 530, 531, 532, 533, 534, 535, 536, 537, 538, 539, 540, 541, 542, 543, 544, 545, 546, 547, 548, 549, 550, 551, 552, 553, 554, 555, 556, 557, 558, 559, 560, 561, 562, 563, 564, 565, 566, 567, 568, 569, 570, 571, 572, 573, 574, 575, 576, 577, 578, 579, 580, 581, 582, 583, 584, 585, 586, 587, 588, 589, 590, 591, 592, 593, 594, 595, 596, 597, 598, 599, 600, 601, 602, 603, 604, 605, 606, 607, 608, 609, 610, 611, 612, 613, 614, 615, 616, 617, 618, 619, 620, 621, 622, 623, 624, 625, 626, 627, 628, 629, 630, 631, 632, 633, 634, 635, 636, 637, 638, 639, 640, 641, 642, 643, 644, 645, 646, 647, 648, 649, 650, 651, 652, 653, 654, 655, 656, 657, 658, 659, 660, 661, 662, 663, 664, 665, 666, 667, 668, 669, 670, 671, 672, 673, 674, 675, 676, 677, 678, 679, 680, 681, 682, 683, 684, 685, 686, 687, 688, 689, 690, 691, 692, 693, 694, 695, 696, 697, 698, 699, 700, 701, 702, 703, 704, 705, 706, 707, 708, 709, 710, 711, 712, 713, 714, 715, 716, 717, 718, 719, 720, 721, 722, 723, 724, 725, 726, 727, 728, 729, 730, 731, 732, 733, 734, 735, 736, 737, 738, 739, 740, 741, 742, 743, 744, 745, 746, 747, 748, 749, 750, 751, 752, 753, 754, 755, 756, 757, 758, 759, 760, 761, 762, 763, 764, 765, 766, 767, 768, 769, 770, 771, 772, 773, 774, 775, 776, 777, 778, 779, 780, 781, 782, 783, 784, 785, 786, 787, 788, 789, 790, 791, 792, 793, 794, 795, 796, 797, 798, 799, 800, 801, 802, 803, 804, 805, 806, 807, 808, 809, 810, 811, 812, 813, 814, 815, 816, 817, 818, 819, 820, 821, 822, 823, 824, 825, 826, 827, 828, 829, 830, 831, 832, 833, 834, 835, 836, 837, 838, 839, 840, 841, 842, 843, 844, 845, 846, 847, 848, 849, 850, 851, 852, 853, 854, 855, 856, 857, 858, 859, 860, 861, 862, 863, 864, 865, 866, 867, 868, 869, 870, 871, 872, 873, 874, 875, 876, 877, 878, 879, 880, 881, 882, 883, 884, 885, 886, 887, 888, 889, 890, 891, 892, 893, 894, 895, 896, 897, 898, 899, 900, 901, 902, 903, 904, 905, 906, 907, 908, 909, 910, 911, 912, 913, 914, 915, 916, 917, 918, 919, 920, 921, 922, 923, 924, 925, 926, 927, 928, 929, 930, 931, 932, 933, 934, 935, 936, 937, 938, 939, 940, 941, 942, 943, 944, 945, 946, 947, 948, 949, 950, 951, 952, 953, 954, 955, 956, 957, 958, 959, 960, 961, 962, 963, 964, 965, 966, 967, 968, 969, 970, 971, 972, 973, 974, 975, 976, 977, 978, 979, 980, 981, 982, 983, 984, 985, 986, 987, 988, 989, 990, 991, 992, 993, 994, 995, 996, 997, 998, 999, 1000.

USE GROUP II, 3-8% SLOPES.
 600 GPD LOADING
 (600 GPD) X 1.3 = 780 GPD (16,688 Gp-ft)
 4. 0.408 ACRES (7,671 Sq-ft) 75' WELL (RWH)
 REQUIRED
 LOT SIZE: 2.04 ACRES
Contractor Notes
 1. ALL MATERIAL SHALL BE PLACED IN THE MIDDLE OF THE LOT.
 2. REMOVE ALL TOPSOIL AND RAKE BED BEFORE PLACEMENT
 3. ALL MATERIAL SHALL BE PLACED IN THE MIDDLE OF THE LOT.
 4. MATERIAL SHALL BE PLACED IN THE MIDDLE OF THE LOT.
 5. MATERIAL SHALL BE PLACED IN THE MIDDLE OF THE LOT.
 6. MATERIAL SHALL BE PLACED IN THE MIDDLE OF THE LOT.
 7. MATERIAL SHALL BE PLACED IN THE MIDDLE OF THE LOT.
 8. MATERIAL SHALL BE PLACED IN THE MIDDLE OF THE LOT.
 9. MATERIAL SHALL BE PLACED IN THE MIDDLE OF THE LOT.
 10. MATERIAL SHALL BE PLACED IN THE MIDDLE OF THE LOT.
 11. MATERIAL SHALL BE PLACED IN THE MIDDLE OF THE LOT.
 12. MATERIAL SHALL BE PLACED IN THE MIDDLE OF THE LOT.
 13. MATERIAL SHALL BE PLACED IN THE MIDDLE OF THE LOT.
 14. MATERIAL SHALL BE PLACED IN THE MIDDLE OF THE LOT.
 15. MATERIAL SHALL BE PLACED IN THE MIDDLE OF THE LOT.
 16. MATERIAL SHALL BE PLACED IN THE MIDDLE OF THE LOT.
 17. MATERIAL SHALL BE PLACED IN THE MIDDLE OF THE LOT.
 18. MATERIAL SHALL BE PLACED IN THE MIDDLE OF THE LOT.
 19. MATERIAL SHALL BE PLACED IN THE MIDDLE OF THE LOT.
 20. MATERIAL SHALL BE PLACED IN THE MIDDLE OF THE LOT.
 21. MATERIAL SHALL BE PLACED IN THE MIDDLE OF THE LOT.
 22. MATERIAL SHALL BE PLACED IN THE MIDDLE OF THE LOT.
 23. MATERIAL SHALL BE PLACED IN THE MIDDLE OF THE LOT.
 24. MATERIAL SHALL BE PLACED IN THE MIDDLE OF THE LOT.
 25. MATERIAL SHALL BE PLACED IN THE MIDDLE OF THE LOT.
 26. MATERIAL SHALL BE PLACED IN THE MIDDLE OF THE LOT.
 27. MATERIAL SHALL BE PLACED IN THE MIDDLE OF THE LOT.
 28. MATERIAL SHALL BE PLACED IN THE MIDDLE OF THE LOT.
 29. MATERIAL SHALL BE PLACED IN THE MIDDLE OF THE LOT.
 30. MATERIAL SHALL BE PLACED IN THE MIDDLE OF THE LOT.
 31. MATERIAL SHALL BE PLACED IN THE MIDDLE OF THE LOT.
 32. MATERIAL SHALL BE PLACED IN THE MIDDLE OF THE LOT.
 33. MATERIAL SHALL BE PLACED IN THE MIDDLE OF THE LOT.
 34. MATERIAL SHALL BE PLACED IN THE MIDDLE OF THE LOT.
 35. MATERIAL SHALL BE PLACED IN THE MIDDLE OF THE LOT.
 36. MATERIAL SHALL BE PLACED IN THE MIDDLE OF THE LOT.
 37. MATERIAL SHALL BE PLACED IN THE MIDDLE OF THE LOT.
 38. MATERIAL SHALL BE PLACED IN THE MIDDLE OF THE LOT.
 39. MATERIAL SHALL BE PLACED IN THE MIDDLE OF THE LOT.
 40. MATERIAL SHALL BE PLACED IN THE MIDDLE OF THE LOT.
 41. MATERIAL SHALL BE PLACED IN THE MIDDLE OF THE LOT.
 42. MATERIAL SHALL BE PLACED IN THE MIDDLE OF THE LOT.
 43. MATERIAL SHALL BE PLACED IN THE MIDDLE OF THE LOT.
 44. MATERIAL SHALL BE PLACED IN THE MIDDLE OF THE LOT.
 45. MATERIAL SHALL BE PLACED IN THE MIDDLE OF THE LOT.
 46. MATERIAL SHALL BE PLACED IN THE MIDDLE OF THE LOT.
 47. MATERIAL SHALL BE PLACED IN THE MIDDLE OF THE LOT.
 48. MATERIAL SHALL BE PLACED IN THE MIDDLE OF THE LOT.
 49. MATERIAL SHALL BE PLACED IN THE MIDDLE OF THE LOT.
 50. MATERIAL SHALL BE PLACED IN THE MIDDLE OF THE LOT.
 51. MATERIAL SHALL BE PLACED IN THE MIDDLE OF THE LOT.
 52. MATERIAL SHALL BE PLACED IN THE MIDDLE OF THE LOT.
 53. MATERIAL SHALL BE PLACED IN THE MIDDLE OF THE LOT.
 54. MATERIAL SHALL BE PLACED IN THE MIDDLE OF THE LOT.
 55. MATERIAL SHALL BE PLACED IN THE MIDDLE OF THE LOT.
 56. MATERIAL SHALL BE PLACED IN THE MIDDLE OF THE LOT.
 57. MATERIAL SHALL BE PLACED IN THE MIDDLE OF THE LOT.
 58. MATERIAL SHALL BE PLACED IN THE MIDDLE OF THE LOT.
 59. MATERIAL SHALL BE PLACED IN THE MIDDLE OF THE LOT.
 60. MATERIAL SHALL BE PLACED IN THE MIDDLE OF THE LOT.
 61. MATERIAL SHALL BE PLACED IN THE MIDDLE OF THE LOT.
 62. MATERIAL SHALL BE PLACED IN THE MIDDLE OF THE LOT.
 63. MATERIAL SHALL BE PLACED IN THE MIDDLE OF THE LOT.
 64. MATERIAL SHALL BE PLACED IN THE MIDDLE OF THE LOT.
 65. MATERIAL SHALL BE PLACED IN THE MIDDLE OF THE LOT.
 66. MATERIAL SHALL BE PLACED IN THE MIDDLE OF THE LOT.
 67. MATERIAL SHALL BE PLACED IN THE MIDDLE OF THE LOT.
 68. MATERIAL SHALL BE PLACED IN THE MIDDLE OF THE LOT.
 69. MATERIAL SHALL BE PLACED IN THE MIDDLE OF THE LOT.
 70. MATERIAL SHALL BE PLACED IN THE MIDDLE OF THE LOT.
 71. MATERIAL SHALL BE PLACED IN THE MIDDLE OF THE LOT.
 72. MATERIAL SHALL BE PLACED IN THE MIDDLE OF THE LOT.
 73. MATERIAL SHALL BE PLACED IN THE MIDDLE OF THE LOT.
 74. MATERIAL SHALL BE PLACED IN THE MIDDLE OF THE LOT.
 75. MATERIAL SHALL BE PLACED IN THE MIDDLE OF THE LOT.
 76. MATERIAL SHALL BE PLACED IN THE MIDDLE OF THE LOT.
 77. MATERIAL SHALL BE PLACED IN THE MIDDLE OF THE LOT.
 78. MATERIAL SHALL BE PLACED IN THE MIDDLE OF THE LOT.
 79. MATERIAL SHALL BE PLACED IN THE MIDDLE OF THE LOT.
 80. MATERIAL SHALL BE PLACED IN THE MIDDLE OF THE LOT.
 81. MATERIAL SHALL BE PLACED IN THE MIDDLE OF THE LOT.
 82. MATERIAL SHALL BE PLACED IN THE MIDDLE OF THE LOT.
 83. MATERIAL SHALL BE PLACED IN THE MIDDLE OF THE LOT.
 84. MATERIAL SHALL BE PLACED IN THE MIDDLE OF THE LOT.
 85. MATERIAL SHALL BE PLACED IN THE MIDDLE OF THE LOT.
 86. MATERIAL SHALL BE PLACED IN THE MIDDLE OF THE LOT.
 87. MATERIAL SHALL BE PLACED IN THE MIDDLE OF THE LOT.
 88. MATERIAL SHALL BE PLACED IN THE MIDDLE OF THE LOT.
 89. MATERIAL SHALL BE PLACED IN THE MIDDLE OF THE LOT.
 90. MATERIAL SHALL BE PLACED IN THE MIDDLE OF THE LOT.
 91. MATERIAL SHALL BE PLACED IN THE MIDDLE OF THE LOT.
 92. MATERIAL SHALL BE PLACED IN THE MIDDLE OF THE LOT.
 93. MATERIAL SHALL BE PLACED IN THE MIDDLE OF THE LOT.
 94. MATERIAL SHALL BE PLACED IN THE MIDDLE OF THE LOT.
 95. MATERIAL SHALL BE PLACED IN THE MIDDLE OF THE LOT.
 96. MATERIAL SHALL BE PLACED IN THE MIDDLE OF THE LOT.
 97. MATERIAL SHALL BE PLACED IN THE MIDDLE OF THE LOT.
 98. MATERIAL SHALL BE PLACED IN THE MIDDLE OF THE LOT.
 99. MATERIAL SHALL BE PLACED IN THE MIDDLE OF THE LOT.
 100. MATERIAL SHALL BE PLACED IN THE MIDDLE OF THE LOT.